

The DM-1300 is a microphone suited to both vocal and speech applications.



Article number:DM-1300

Specifications

Control keys, buttons and knobs	Talk switch: Short-off type, slide on/off switch
Directivity	Unidirectional
Frequency response.	70 Hz - 15 kHz
Connection	3-pin XLR jack
Microphone sensitivity	-54 dB (1 kHz 0 dB = 1 V/Pa)
Rated impedance	600 Ω
Control keys, buttons and knobs	Talk switch: Short-off type, slide on/off switch
Frequency response.	70 Hz - 15 kHz
Microphone type.	Dynamic microphone
Directivity	Unidirectional
Microphone sensitivity	-54 dB (1 kHz 0 dB = 1 V/Pa)
Rated impedance	600 Ω
Finish.	Zinc, die-cast, paint, grey metallic,

Appearance

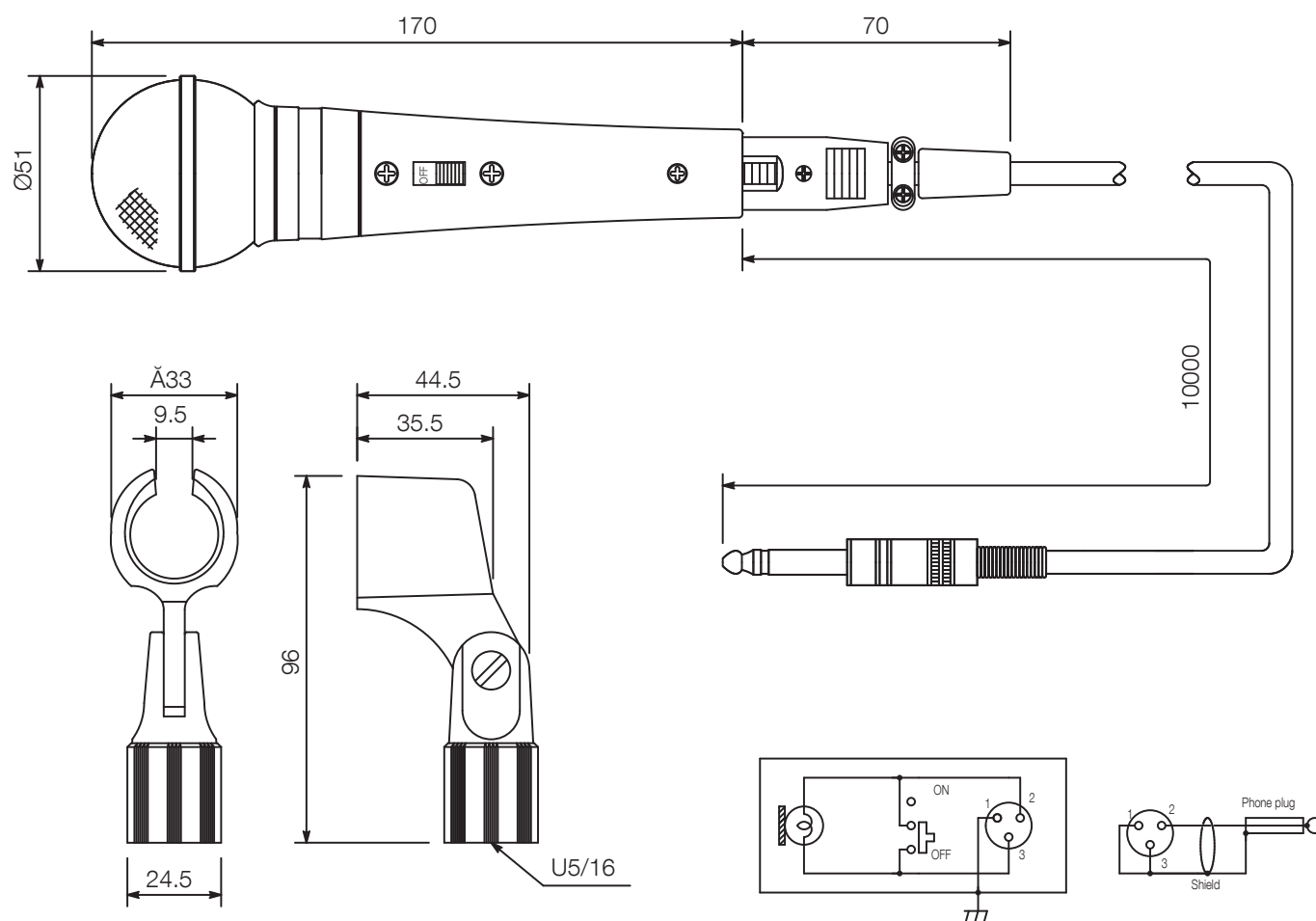

UNIT:mm

SCALE:1/2

Circuit Diagram