



## EWS-206B/6

### CABINET LOUDSPEAKER

#### FEATURES

- Extraordinary sound and music reproduction
- Bass and Treble separate frequency design
- Available in black and white
- Strong white ABS cover
- Wall mounting
- Compliance with international safety standards

EWS-206B/6 is a part of EWS-206W/B indoor cabinet loudspeaker family, functioned with Bass and Treble separate frequency. The black 60W rectangle cabinet provides superb sound quality and music reproduction to meet demands of different applications such as hotels, office buildings, conference centers, factories, and exhibition halls. On the back of the loudspeaker, there is a rack mount power tapping switch for the convenient use. It is made of high compact ABS material for low weight.

The cabinet is equipped with exclusive installation racks so that user can quickly and easily mount the device on the wall. The screw racks on the top and bottom are used to horizontally adjust the direction of the loudspeaker.

#### SPECIFICATIONS

Model	EWS-206B/6
Max Power	80 W
Rated Power	60 W
Power taps @100V	60 W / 30 W / 15 W
Power taps @70V	30 W / 15 W / 7.5 W
Sensitivity	87.7 dB
Max sound pressure level (1 m)	104 dB
Frequency range (-10 dB)	75 Hz - 20 KHz
Dispersion angle	135°
Rated input voltage	70 V / 100 V
Rated impedance	167 Ω / 333 Ω / 667 Ω
Dimensions (W x H x D)	193 × 344 × 202 mm
Diameter of speaker	25mm × 1 (Treble) + 6" × 1 (Bass)
Weight	3.8 kg
Material	ABS
Color	Black

#### ORDERING INFORMATION

**EWS-206B/6**

60 W , 6" Plastic Cabinet Loudspeaker, Black

## THREE-VIEW DIAGRAM

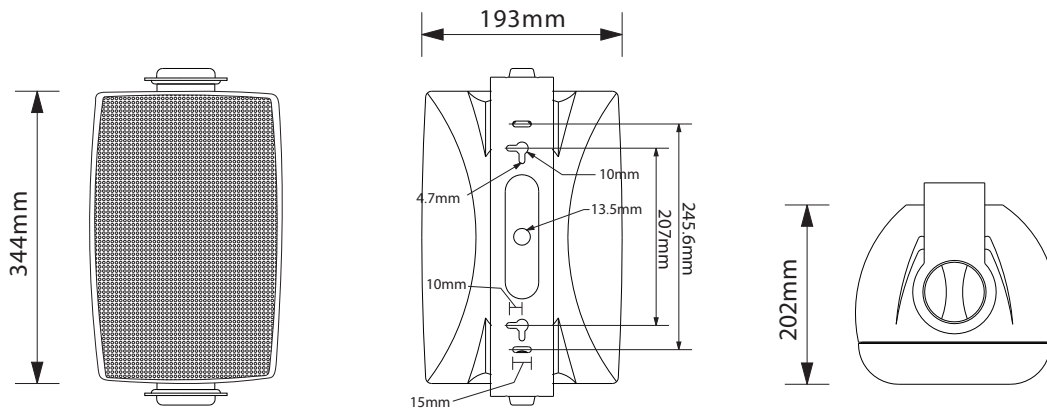

## DIRECTION DIAGRAM

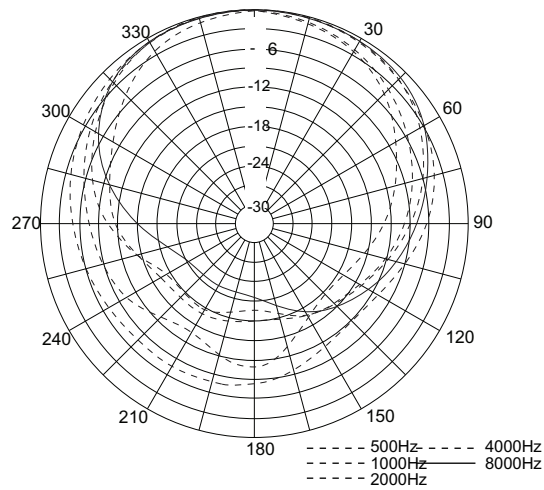

## CIRCUIT DIAGRAM

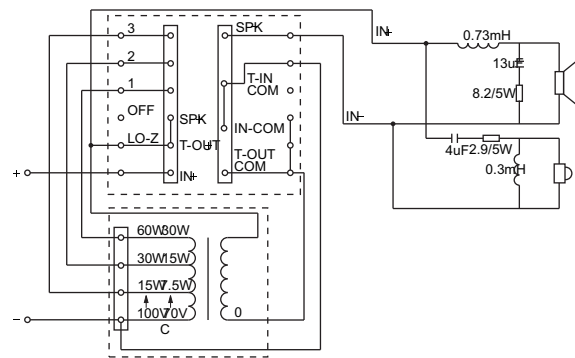

## Frequency Response at dBspl(20uPa)@1m, 60W/100V input, 1/3 oct smoothing)

